

morselli e maccaferri

S.r.l.



*Costruzione e revisione attrezzature
Per la viabilità e l'ambiente
Construction and overhauling of road
Clearing and environmental equipment*

Via Dell'Industria 11-41010 - Piumazzo (Mo) - Italy - Tel. **(059)931483** - Fax. **(059)934307**
Albo Nazionale Costruttori n° 7849602 - P.iva 02659480368
Internet www.morselliemaccaferri.com e-mail morsemac@tin.it

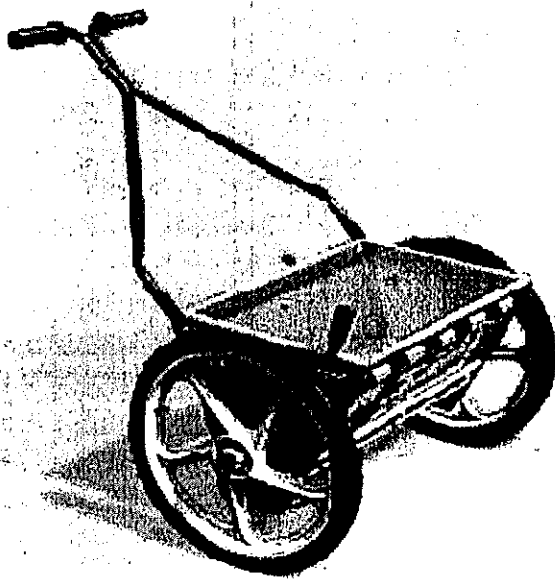

**SPARGITORE
SPREADER
STREUER
EPANDEUR**

MODEL

M50

**MANUALE USO E MANUTENZIONE , DATI TECNICI E CATALOGO RICAMBI
USE AND MAINTENANCE , TECHNICAL DATA AND SPARE PARTS
BEDIENUNGS und WARTUNGSANLEITUNG, TECHNISCHE DATEN – ERSATZTEILE
MANUEL D'ENTRETIEN, CARACTERISTIQUES TECHNIQUES – PIECES DETACHEE**

1.06.MAN.1.ITA – Rev. 1 21/11/2001



HAFOG
Salg . Service . Fabrikation . Import
Lyngager 5-11 2605 Brøndby
Telefon 43 96 66 11 . Fax 43 26 66 24

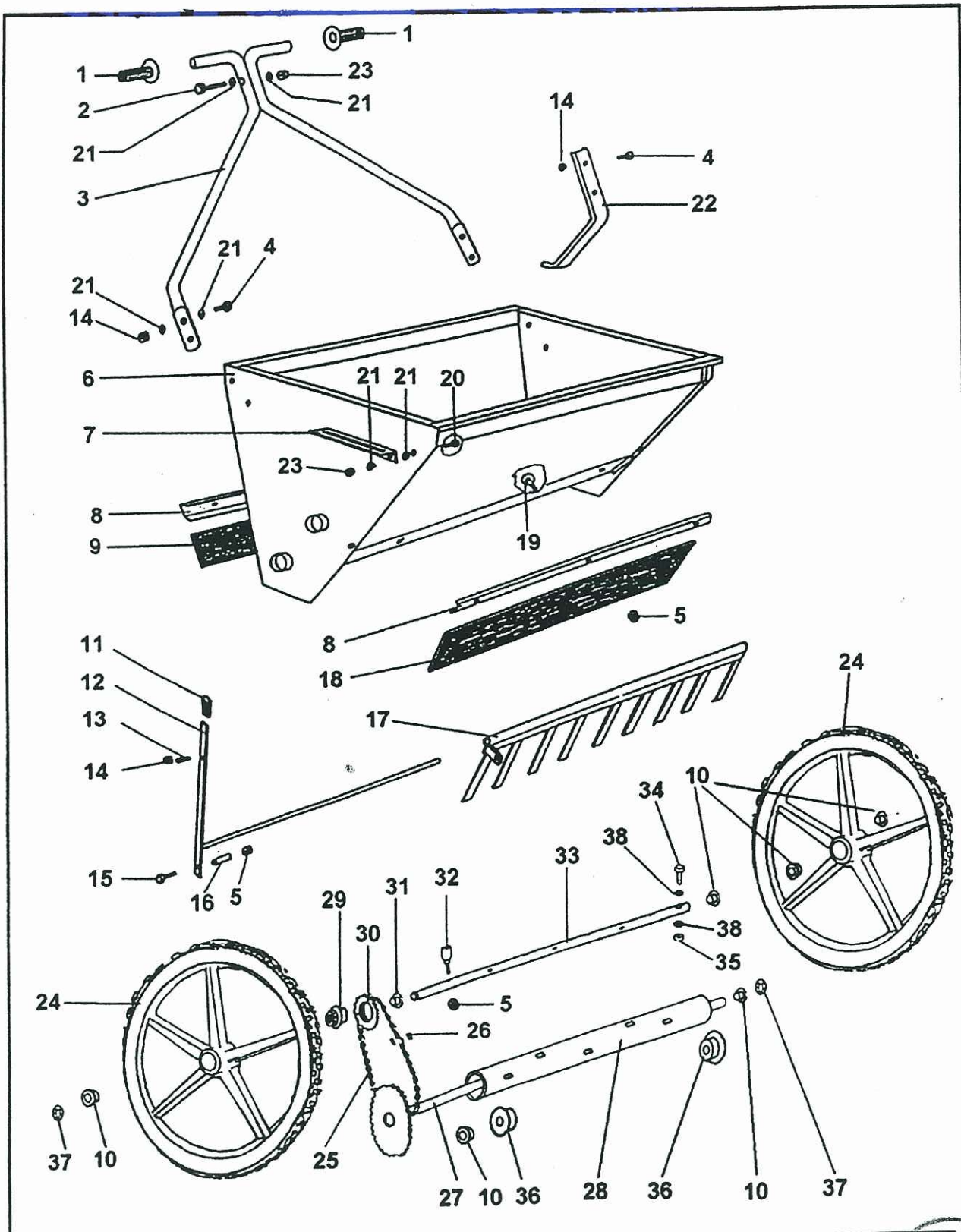

**morselli e
maccaferri**
srl

Dis. n° 1.06.000.0 **ESPLOSO M50**

HAFOG
 Salg . Service . Fabrikation . Import
 Lyngager 5-11 2605 Brøndby
 Telefon 43 96 66 11 , Fax 43 26 66 24

Rif	Codice	Descrizione	Description	Bezeichnung	Dèscription	Q.
	1.06.000.0	ESPLOSO	TABLE	TAFEL	TABLE	
1	9.05.351.0	Manopola	Handle knob	Griffe	Poignée	2
2	/	Vite M6x60	Screw M6x60	Schraube M6x60	Vis M6x60	1
3	1.06.001.0	Stegola	Handlebars	Holme	Mancherons	2
4	/	Vite M8x20	Screw M8x20	Schraube M8x20	Vis M8x20	6
5	/	Dado autoblock M8	Selflocking nut M8	Selbstsitz. Mutter M8	Ecrou de sûreté M8	6
6	1.06.002.0	Tramoggia	Hopper	Streukasten	Trémie	1
7	1.06.005.0	Indice	Index	Anzeige	Indicateur	1
8	1.06.006.0	Supporto lastra gomma	Rubber support	Halteleiste	Support caoutchouc	2
9	1.06.007.0	Gomma posteriore	Rear spread. Rubber	Hintere Gummileiste	Caoutchouc postérieur	1
10	1.06.019.0	Boccola nylon	Nylon bushing	Achsenbüchse nylon	Coquille en nylon	6
11	9.05.380.0	Impugnatura	Handle knob	Drehknopf	Poignée	1
12	1.06.010.0	Leva	Lever	Hebel	Levier	1
13	/	Grano testa piana M8	Screw M8	Schraube M8	Vis M8	1
14	/	Dado M8	Nut M8	Mutter M8	Ecrou M8	18
15	/	Vite M8x40	Screw M8x40	Schraube M8x40	Vis M8x40	1
16	1.06.017.0	Distanziale	Spacer	Distanzstücke	Entretoise	1
17	1.06.011.0	Supporto porta molle	Spring support	Halteleiste	Support ressort	1
18	1.06.008.0	Gomma anteriore	Front spread. Rubber	Vodere Gummileiste	Caoutchouc antérieur	1
19	/	Cavicchia M8x25	Screw M8x25	Schraube M8x25	Vis M8x25	6
20	/	Vite M6x20	Screw M6x20	Schraube M6x20	Vis M6x20	2
21	/	Rondella Ø 8 mm	Washer Ø 8 mm	Scheibe Ø 8 mm	Rondelle Ø 8 mm	6
22	1.06.012.0	Piede	Foot	Fuß	Pied	1
23	/	Dado autoblock M6	Self-locking nut M6	Selbstsic. Mutter M6	Ecrou de sûreté M6	3
24	9.05.202.0	Ruota	Wheel	Rad	Roue	2
25	9.04.700.0	Catena	Chain	Kette	Chaîne	1
26	9.04.701.0	Maglia giunzione catena	Chain jointure	Kettenschloß	Jonction pour chaîne	1
27	1.06.013.0	Perno albero spargitore	Spreading shaft	Strengwelle	Arbre épandage	1
28	1.06.014.0	Albero spargitore	Spreading roll	Walze	Rouleau	1
29	9.04.450.0	Boccola speciale	Special bushing	Achsenbüchse	Coquille	1
30	9.04.800.0	Ruota libera Z=16	Pinion gear Z=16	Kettenrad Z=16	Pignon Z=16	1
31	1.06.018.0	Boccola speciale	Special bushing	Achsenbüchse	Coquille	2
32	1.06.015.0	Dente	Spreading tooth	Mitnehmer	Dent rouleau	10
33	1.06.016.0	Albero frantumatore	Mixer roller	Mischerbaum	Arbre de mélangeur	1
34	/	Vite M5x45	Screw M5x45	Schraube M5x45	Vis M5x45	1
35	/	Dado M5	Nut M5	Mutter M5	Ecrou M5	1
36	1.06.009.0	Boccola per albero frant.	Bushing mixer roller	Achsenbüchse	Coquille arbre mélangeur	2
37	/	Prestola Ø 20 mm	Safety washer Ø 20 mm	Splint schiebe Ø 20 mm	Goupille rondelle Ø 20 mm	2
38	/	Prestola Ø 5 mm	Washer Ø 5 mm	Scheibe Ø 5 mm	Rondelle Ø 5 mm	2



Morselli e Maccaferri

l.s.e.srl

*Costruzione e revisione attrezzature
Per la viabilità e l'ambiente
Construction and overhauling of road
Clearing and environmental equipment*

Via Maestri del Lavoro, 9 - 41010 - Piumazzo (Mo) - Italy - Tel. **(059)931362** - Fax. **(059)9533241**
Albo Nazionale Costruttori n° 7849602 - P.iva 02991370368
Internet www.morsellimaccaferri.eu
e-mail info@morsellimaccaferri.eu

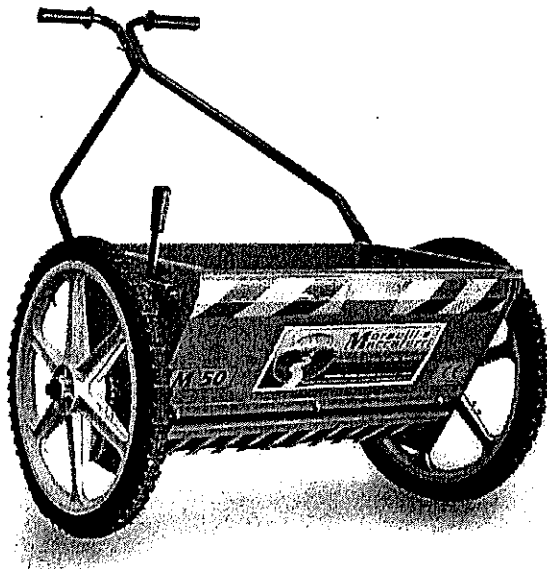

**SPARGITORE
SPREADER
STREUER
EPANDEUR**

MODEL

M50

INOX

 **HAFOG**
Salg . Service . Fabrikation . Import
Lyngager 5-11 2605 Brøndby
Telefon 43 96 66 11 . Fax 43 26 66 24

**MANUALE USO E MANUTENZIONE , DATI TECNICI E CATALOGO RICAMBI
USE AND MAINTENANCE , TECHNICAL DATA AND SPARE PARTS
BEDIENUNGS und WARTUNGSANLEITUNG, TECHNISCHE DATEN – ERSATZTEILE
MANUEL D'ENTRETIEN, CARACTERISTIQUES TECHNIQUES – PIECES DETACHEE**

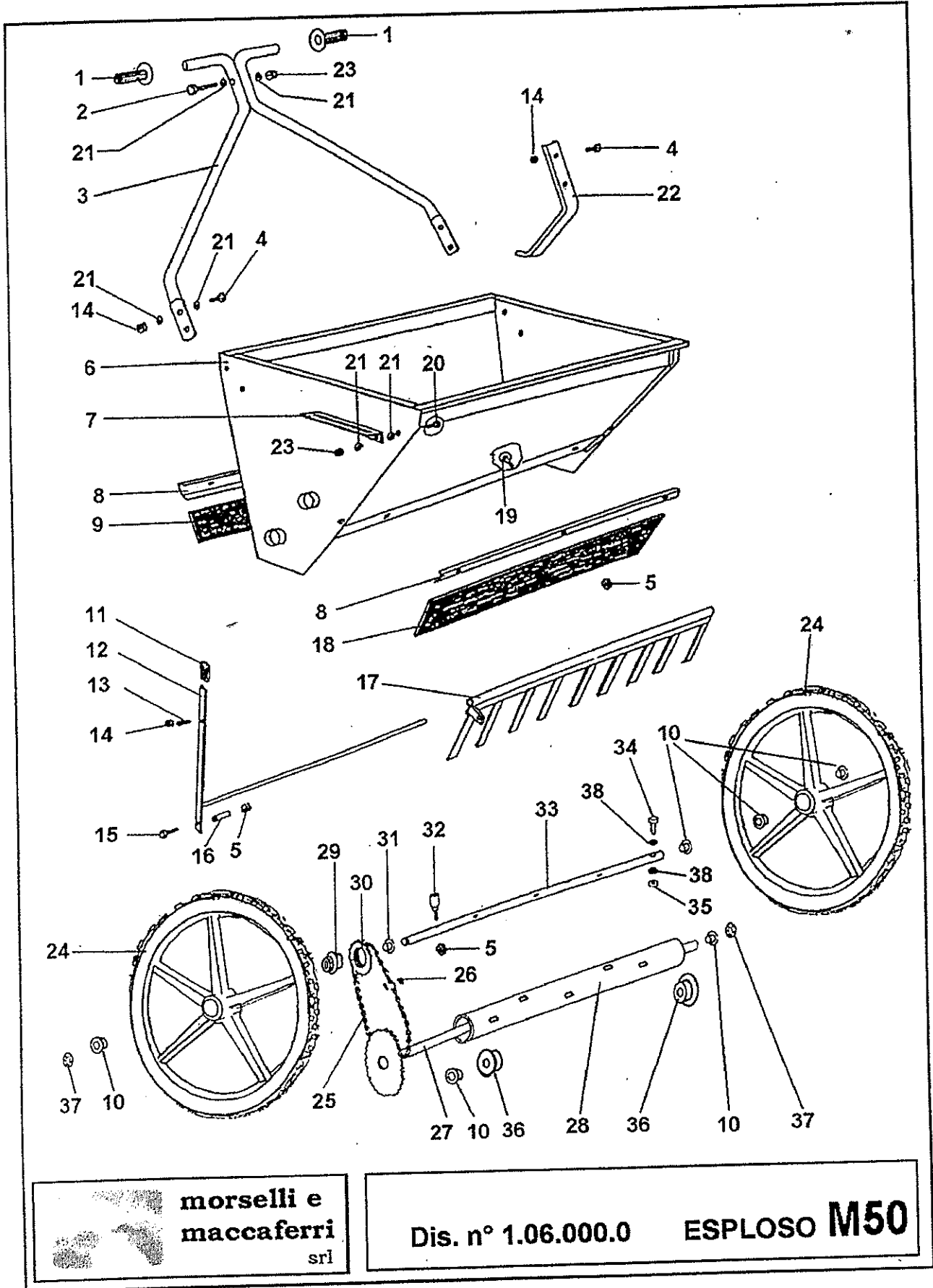



morselli e maccaferri
 srl

Dis. n° 1.06.000.0 ESPLOSO M50

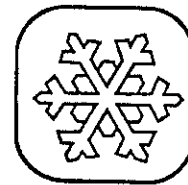

HAFAG
 Salg . Service . Fabrikation . Import
 Lyngager 5-11 2605 Brøndby
 Telefon 43 96 66 11 Fax 43 26 66 24

Rif	Codice	Descrizione	Description	Bezeichnung	Déscription	Q.
	1.06.000.0	ESPLOSO	TABLE	TAFEL	TABLE	
1	9.05.351.0	Manopola	Handle knob	Griffe	Poignée	2
2		Vite M6x60	Screw M6x60	Schraube M6x60	Vis M6x60	2
3	1.06.021.0	Stegola	Handlebars	Holme	Mancherons	2
4		Vite M8x20	Screw M8x20	Schraube M8x20	Vis M8x20	6
5		Dado autoblock M8	Selflocking nut M8	Selbstsitz. Mutter M8	Ecrou de sûreté M8	14
6	1.06.022.0	Tramoggia	Hopper	Streukasten	Trémie	1
7	1.06.023.0	Indice	Index	Anzeige	Indicateur	1
8	1.06.024.0	Supporto lastra gomma	Rubber support	Halteleiste	Support caoutchouc	2
9	1.06.007.0	Gomma posteriore	Rear spread. Rubber	Hintere Gummileiste	Caoutc. postérieur	1
10	1.06.019.0	Boccola nylon	Nylon bushing	Achsenbüchse nylon	Coquille en nylon	6
11	9.05.380.0	Impugnatura	Handle knob	Drehknopf	Poignée	1
12	1.06.025.0	Leva	Lever	Hebel	Levier	1
13		Grano testa piana M8	Screw M8	Schraube M8	Vis M8	1
14		Dado M8	Nut M8	Mutter M8	Ecrou M8	4
15		Vite M8x40	Screw M8x40	Schraube M8x40	Vis M8x40	1
16		Bullone 8x35	Bolt 8x35	Bull 8x35	Bull 8x35	1
16bis		Dadi norm M8	Nut M8	Mutter M8	Surete M8	2
17	1.06.030.0	Supporto porta molle	Spring support	Halteleiste	Support ressort	1
18	1.06.008.0	Gomma anteriore	Front spread. Rubber	Vodere Gummileiste	Caoutchouc antérieur	1
19		Cavicchia M8x25	Screw M8x25	Schraube M8x25	Vis M8x25	6
20		Vite M6x20	Screw M6x20	Schraube M6x20	Vis M6x20	2
21		Rondella Ø 8 mm	Washer Ø 8 mm	Scheibe Ø 8 mm	Rondelle Ø 8 mm	8
22	1.06.026.0	Piede	Foot	Fuß	Pied	1
23		Dado autoblock M6	Self-locking nut M6	Selbstsic. Mutter M6	Ecrou de sûreté M6	4
24	9.05.202.0	Ruota (cerchione)	Wheel	Rad	Roue	2
	9.05.210.0	Camera d'aria	Inner tube	Innerer schlauch	Chambre d'air	
	9.05.211.0	gomma	rubber	Gummi	Gomme	
25	9.04.700.0	Catena	Chain	Kette	Chaîne	1
26	9.04.701.0	Maglia giunzione catena	Chain jointure	Kettenshloß	Jonction pour chaîne	1
27	1.06.027.0	Perno albero spargitore	Spreading shaft	Strengwelle	Arbre épandage	1
28	1.06.028.0	Albero spargitore	Spreading roll	Walze	Rouleau	1
29	9.04.450.0	Boccola speciale	Special bushing	Achsenbüchse	Coquille	1
30	9.04.800.0	Ruota libera Z=16	Pinion gear Z=16	Kettenrad Z=16	Pignon Z=16	1
31	1.06.018.0	Boccola speciale	Special bushing	Achsenbüchse	Coquille	2
32	1.06.029.0	Dente	Spreading tooth	Mitnehmer	Dent rouleau	5
33	1.06.031.0	Albero frantumatore	Mixer roller	Mischerbaum	Arbre de mélangeur	1
34		Vite M5x45	Screw M5x45	Schraube M5x45	Vis M5x45	1
35		Dado M5	Nut M5	Mutter M5	Ecrou M5	1
36	1.06.009.0	Boccola per albero frant.	Bushing mixer roller	Achsenbüchse	Coquille arbre mélan.	2
37	9.01.009.0	Prestola Ø 20 mm	Safety washer Ø 20 mm	Splint schiebe Ø 20 mm	Goup. rond. Ø 20 mm	2
38		Prestola Ø 5 mm	Washer Ø 5 mm	Scheibe Ø 5 mm	Rondelle Ø 5 mm	2

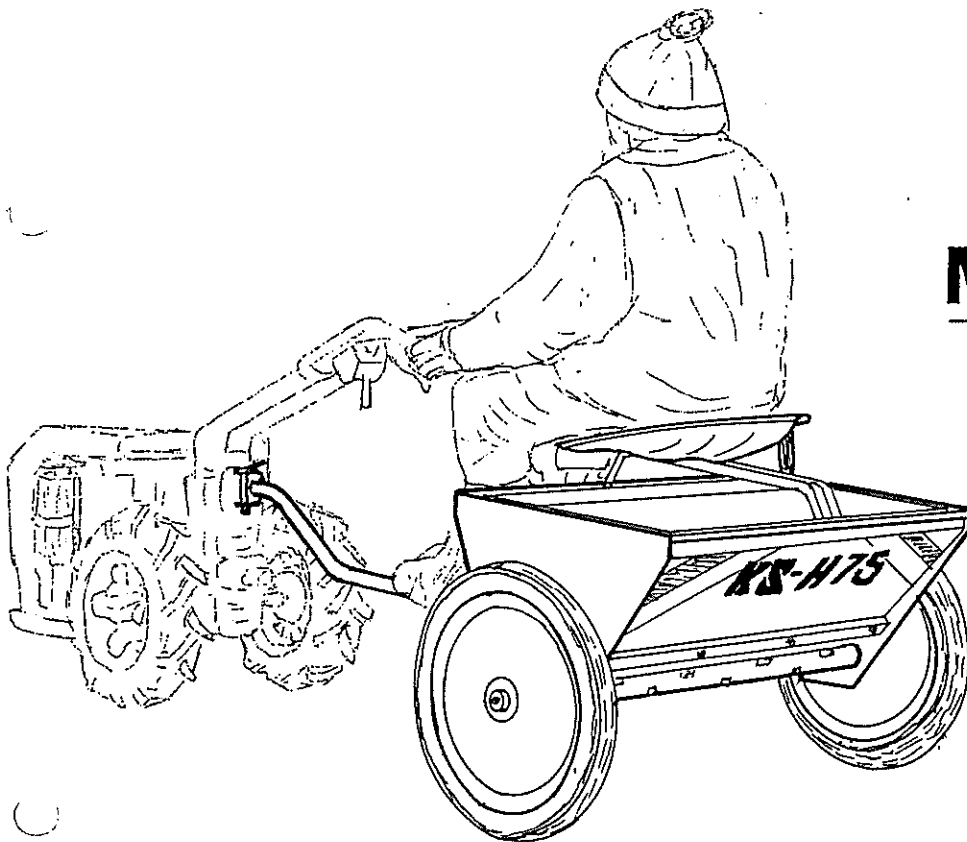

Spreading
Systems
Division

INTERNATIONAL S.r.l.



MODEL H 75

- TECHNICAL DATA
- USE AND MAINTENANCE
- SPARE-PARTS

- TECHNISCHE DATEN
- BEDIENUNGS- und WARTUNGSANLEITUNG
- ERSATZTEILE

- CARACTERISTIQUES TECHNIQUES
- MANUEL D'ENTRETIEN
- PIECES DETACHEES



Salg . Service . Fabrikation . Import
Lyngager 5-11 2605 Brøndby
Telefon 43 96 66 11 . Fax 43 26 66 24

H75

MED NYE NUMRE

5. SPARE PARTS

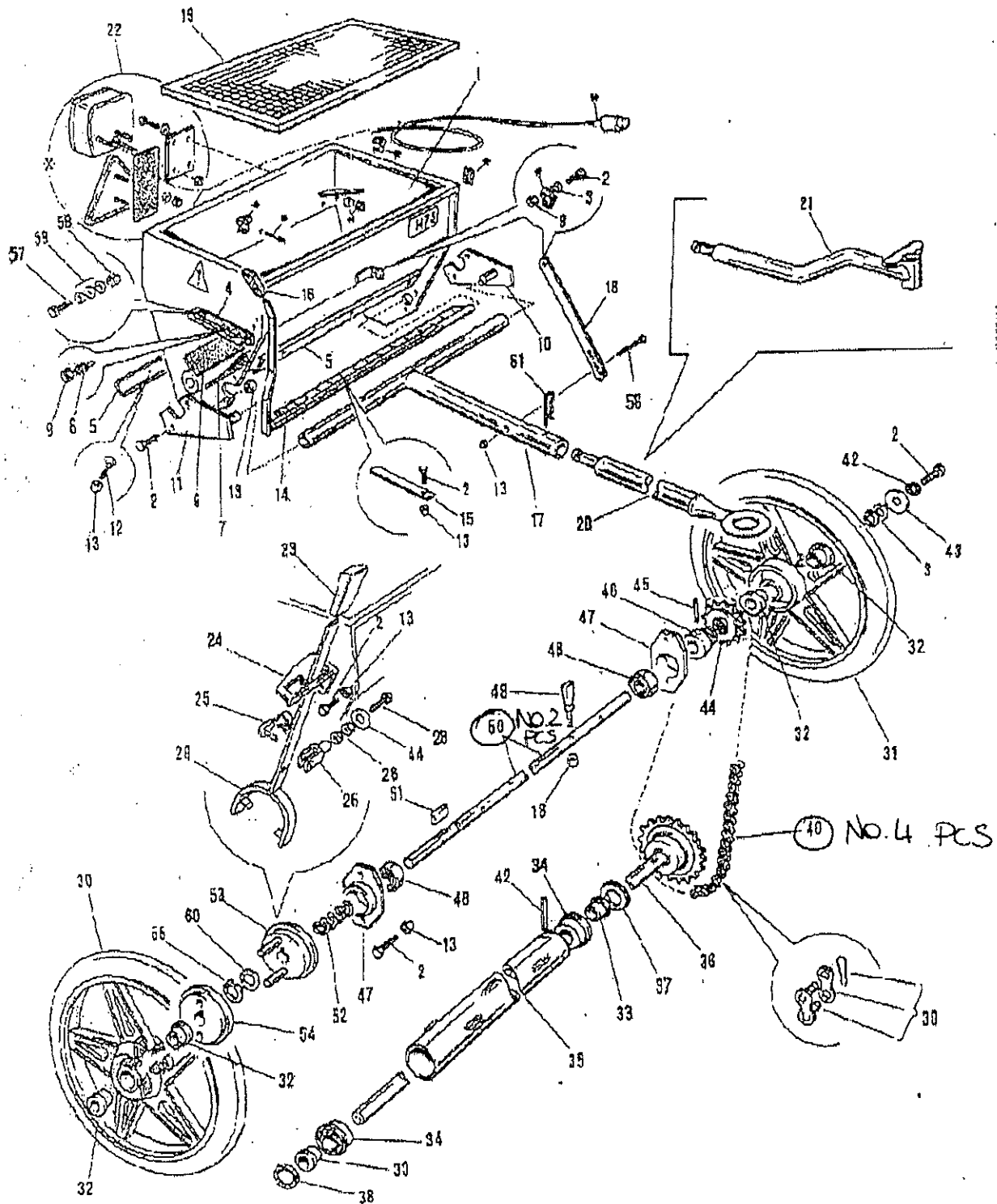

MED NYE NUMRE

morselli e **H75** CATALOGO RICAMBI - SPARE PARTS - ERSATZTEILE - PIECES
 maccaferri DETACHEES

RIF.	CODICE	DESCRIZIONE	EXPLODED VIEW	Q.
		ESPLOSO		
1	6.07.00001	Tramoggia	Hopper	1
2		Vite M8	Screw M8	12
3		Rondella M8	Washer M8	6
4	6.07.00002	Indice	Index	1
5	6.07.00003	Supporto lastra gomma	Rubber support	2
6	6.07.00004	Gomma nera anteriore	Black front rubber	1
7	6.07.00005	Gomma nera posteriore	Black rear rubber	1
8		Vite M8	Screw M8	1
9		Dado M8	Nut M8	6
10	6.07.00006	Attacco timone	Draw coupling	1
11	6.07.00006	Attacco timone	Draw coupling	1
12		Vite M8	Screw M8	6
13		Dado block M8	Selflocking nut M8	38
14	6.07.00007	Barra portamolle	Support spring bar	1
15	6.07.00008	Lamelle di chiusura	Closing bar	17
16	6.07.00009	Manopola	Handle knob	1
17	6.07.00010	Timone	Drawbar	1
18	6.07.00011	Tirante per timone	Drawbar tie rod	1
19	6.07.00012	Vaglio in rete	Wire screen	1
20	6.07.00013	Gancio traino a forcella	Fork pull-hook	1
21	6.07.00014	Gancio di traino	Pull-hook	1
22	6.07.00015	Impianto luci	Light system	1
23	6.07.00016	Manopola	Handle knob	1
24	6.07.00017	Arresto leva innesto	Stop coupling lever	1
25		Forcella	Fork	1
26		Dado M10	Nut M10	2
27		Rondella M10	Washer M10	4
28		Vite M10	Screw M10	1
29	6.07.00018	Leva	Lever	1
30		Ruota DX	Right wheel	1
30	6.07.00019	Camera d'aria	Inner tube	1
30		Gomma	Rubber	1
31		Ruota SX	Left wheel	1
31	6.07.00020	Camera d'aria	Inner tube	1
31		Gomma	Rubber	1
32	6.07.00021	Boccola ruota	Wheel bushing	2
32B	6.07.00022	Boccola ruota	Wheel bushing	2
33	6.07.00023	Boccola	Bushing	2
34	6.07.00024	Boccola	Bushing	2
35	6.07.00025	Rullo spargitore	Spreader roller	1
36	6.07.00026	Albero rullo spargitore	Spreader roller shaft	1
37		Rondella M20	Washer M20	1
38		Prestola Ø 20 mm	Safety washer diam. 20 mm.	1
39	6.07.00027	Giunto catena	Joint chain	1
→ 40	6.07.00028	Catena NO. 4	Chain	1
41		Spina	Pin	1
42		Grower M8	Grower M8	2
43		Rondella M10	Washer M10	2
44	6.07.00029	Pignone ruota libera	Freewheel pinion	1





Salg . Service . Fabrikation . Import
 Lyngager 5-11 2605 Brøndby
 Telefon 43 96 66 11 . Fax 43 26 66 24

MED NYE NUMRE

morselli e maccaferri	H75	CATALOGO RICAMBI - SPAREPARTS - ERSATZTEILE - PIÉCES DETACHÉES
--------------------------	------------	---

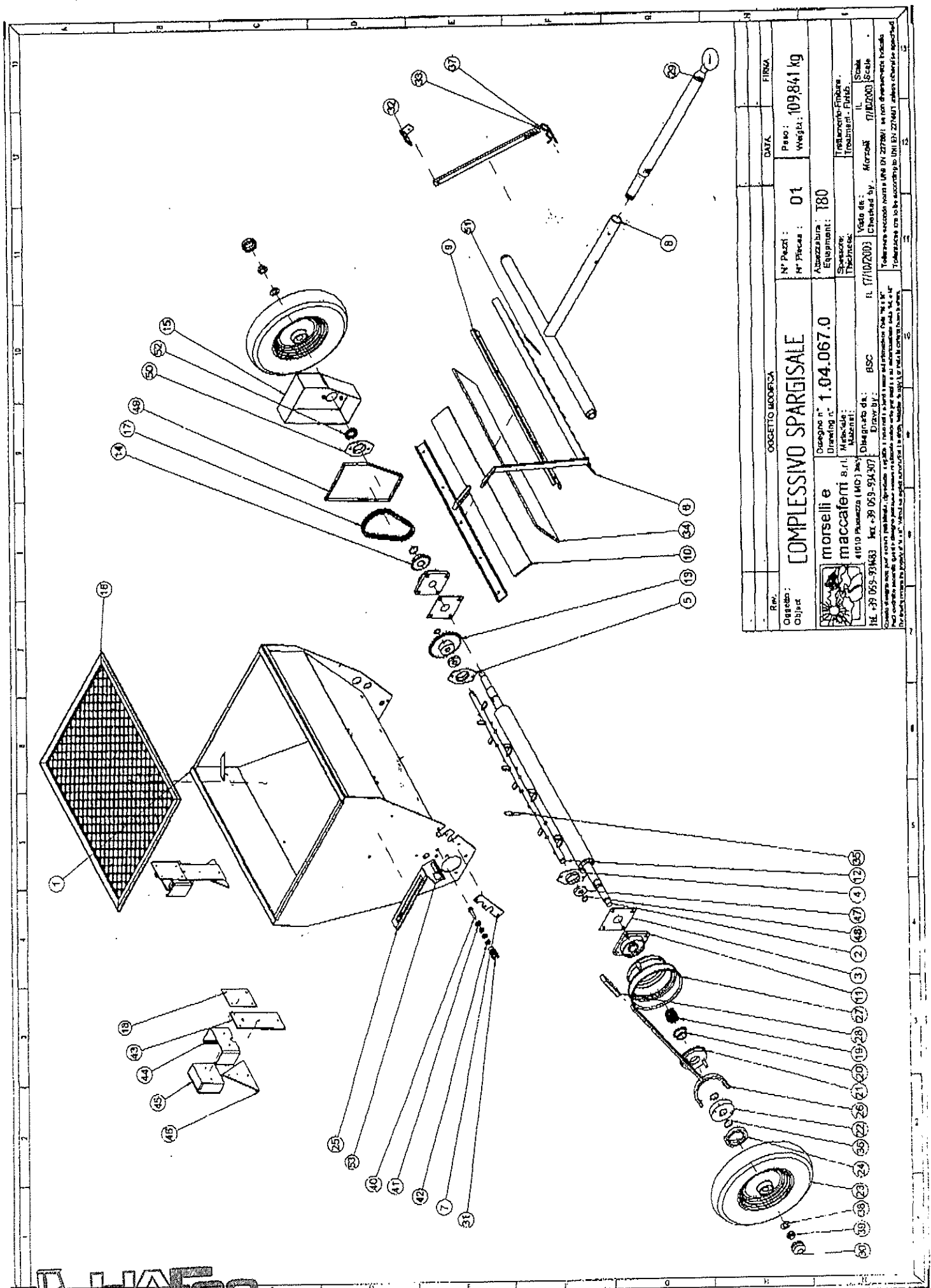
RIF.	CODICE	DESCRIZIONE		Q.
45		Spina elastica	Pin	1
46	6.07.00030	Bussola	Bush	1
47	6.07.00031	Flangia supporto cuscinetto	Bearing support flange	2
48	6.07.00032	Cuscinetto	Bearing	2
49	6.07.00033	Dente	Tooth	7
→ 50	6.07.00034	Rullo frantumatore NO, 2	Mixer roller	1
51		Chiavetta 6x20	Key 6x20	1
52	6.07.00035	Molla comando innesto	Spring for coupling control	1
53	6.07.00036	Innesto frontale	Frontal coupling	1
54	6.07.00037	Anello di trascinamento	Capstan ring	1
55		Seeger vite M8	Seeger M8	1
56		Vite M8	Screw M8	1
57		Vite M6	Screw M6	2
58		Dado M6	Nut M6	2
59		Rondella M6	Washer M6	6
60	6.07.00038	Supporto seggiolino	Seat support	1
61	6.07.00039	Supporto sedile	Seat support	1



Rev.	OGGETTO MODIFICA		DATA	FIRMA
Objekt	COMPLESSIVO SPARGISALE		N° Parti : 01	Peso : 109,84 kg
 morselli e maccaferri s.r.l. #1010 PAVANZA (MO) (PV) Tel. +39 053-934903 Fax +39 053-934907		Disegno n°: 1.04.067.0 Disegnato da: BSC Disegnato da: BSC Disegnato da: BSC	Equipamento: T80 Spessore: [] Trattamento: Finito	Telaio n°: [] Scala: [] Morsetti: []
Tolleranze secondo norma UNI EN 22768 - in tutti gli spessori Tolleranze tra le superfici in base a UNI EN 22768 - in tutti gli spessori Tolleranze tra le superfici in base a UNI EN 22768 - in tutti gli spessori				

HAFOG
 Salg . Service . Fabrikation . Import
 Lyngager 5-11 2605 Brøndby
 Telefon 43 96 66 11 . Fax 43 26 66 24

5.2 Spare parts

morzelli e Maccaferrri	T80 — CATALOGO RICAMBI — SPARE PARTS
---------------------------	---

RIF. ESPL.	CODICE	DESCRIZIONE	DESCRIPTION	Q.
1	6.04.00001	Complessivo corpo	Hopper	1
2	6.04.00002	Rullo spargitore	Spreader roller	1
3	6.04.00003	Fiangia	Flange	2
4	6.04.00004	Fiangia supporto cuscinetto	Support bearing flange	1
5	6.04.00005	Fiangia supporto cuscinetto	Support bearing flange	1
6	6.04.00006	Barra portamolle	Spring bar support	1
7	6.04.00007	Piatto di bloccaggio	Locking bar	1
8	6.04.00008	Timone	Drawbar	1
9	6.04.00009	Supporto lastra in gomma	Rubber support	2
10	6.04.00010	Gomma posteriore	Rear rubber	1
11	6.04.00011	Cuscinetto rullo rompisaie	Breaking roller bearing	2
12	6.04.00012	Rullo mescolatore	Mixer roller	1
13	6.04.00013	Pignone 1/2" Z=30	Small pinion gear 1/2" Z=30	1
14	6.04.00014	Pignone 1/2" Z=18	Small pinion gear 1/2" Z=18	1
15	6.04.00015	Carter	Gear-box	1
16	6.04.00016	Vaglio	Metallic wire screen	1
17	6.04.00017	Catena (9.04.702.0)	Chain	1
18	6.04.00018	Supporto fanale	Light support	2
19	6.04.00019	Molla comando Innesto	Spring for coupling control	1
20	6.04.00020	Boccola	Bushing	1
21	6.04.00021	Innesto frontale	Frontal coupling	1
22	6.04.00022	Anello di trascinamento	Capstan ring	1
23	6.04.00023	Ruota (CUSCINETTI INCLUSI)	Wheel	2
24	6.04.00024	Anello	Ring	1
25	6.04.00025	Indice	Index	1
26	6.04.00026	Forcella di innesto	Coupling fork	1
27	6.04.00027	Cuffia	Casing	1
28	6.04.00028	Paletta	Handle knob	2
29	6.04.00029	Gancio di traino	Draw hook	1
30	6.04.00030	Cappello	Cap	2
31	6.04.00031	Forcella Innesto	Coupling fork	1
32	6.04.00032	Supporto timone	Drawbar support	1
33	6.04.00033	Tirante per timone	Drawbar tie rod	1
34	6.04.00034	Gomma anteriore	Front rubber	1
35	6.04.00035	Dente spargitore	Spreading tooth	13
36	6.04.00036	Anello elastico	Seeger	3
37	6.04.00037	Chiavetta	Key	1
43	6.04.00038	Supporto triangolo	Triangle support	2
44	6.04.00039	Protezione fanale	Light protection	2
45	6.04.00040	Fanale	Light	2
46	6.04.00041	Triangolo catarifrangente	Reflector triangle	2
47	6.04.00042	Cuscinetto	Bearing	2
48	6.04.00043	Anello elastico	Seeger	2
49	6.04.00044	Guarnizione carter (cm 55)	Gear-box gasket	1
50	6.04.00045	Fiangia supporto parapolvere	Boot flange support	1+1
51	6.04.00046	Lamella	Bar	1
52	6.04.00047	Paraolio	Oil seal	1
53	6.04.00048	Arresto leva	Stop lever	1



Salg . Service . Fabrikation . Import
 Lyngager 5-11 2605 Brøndby
 Telefon 43 96 66 11 . Fax 43 26 66 24